

Stage 25

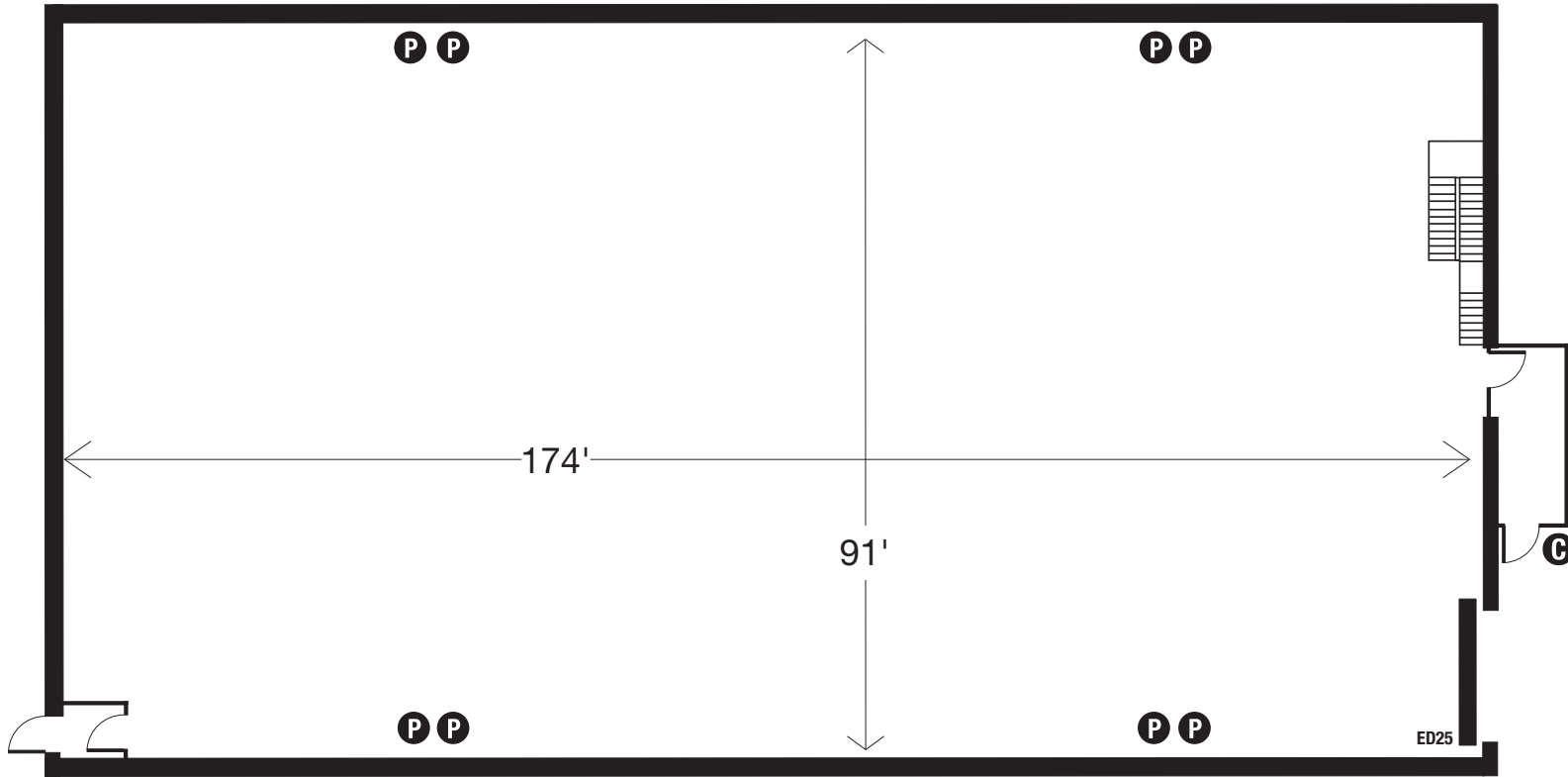

Square Footage 15,900
 Length 174'
 Width 91'
 Pipe Grid Height (underside) 35'
 Elephant Door 16'H x 16'W
 Floor.....Masonite over Plywood

Total Power 9,600A 1Ø AC
 HVAC (Silent) 130 Tons
 Ⓟ Power 400A 3Ø House Switch
 Ⓞ Electronic card entry

STEINER Ⓞ
STUDIOS Ⓞ
15 Ⓞ
WASHINGTON Ⓞ
AVENUE Ⓞ
BROOKLYN Ⓞ
NAVY YARD Ⓞ
NEW YORK Ⓞ
11205 Ⓞ

15 Washington Avenue
 Brooklyn Navy Yard
 New York 11205

Tel 718 858 1600

www.steinerstudios.com