

Stage 26

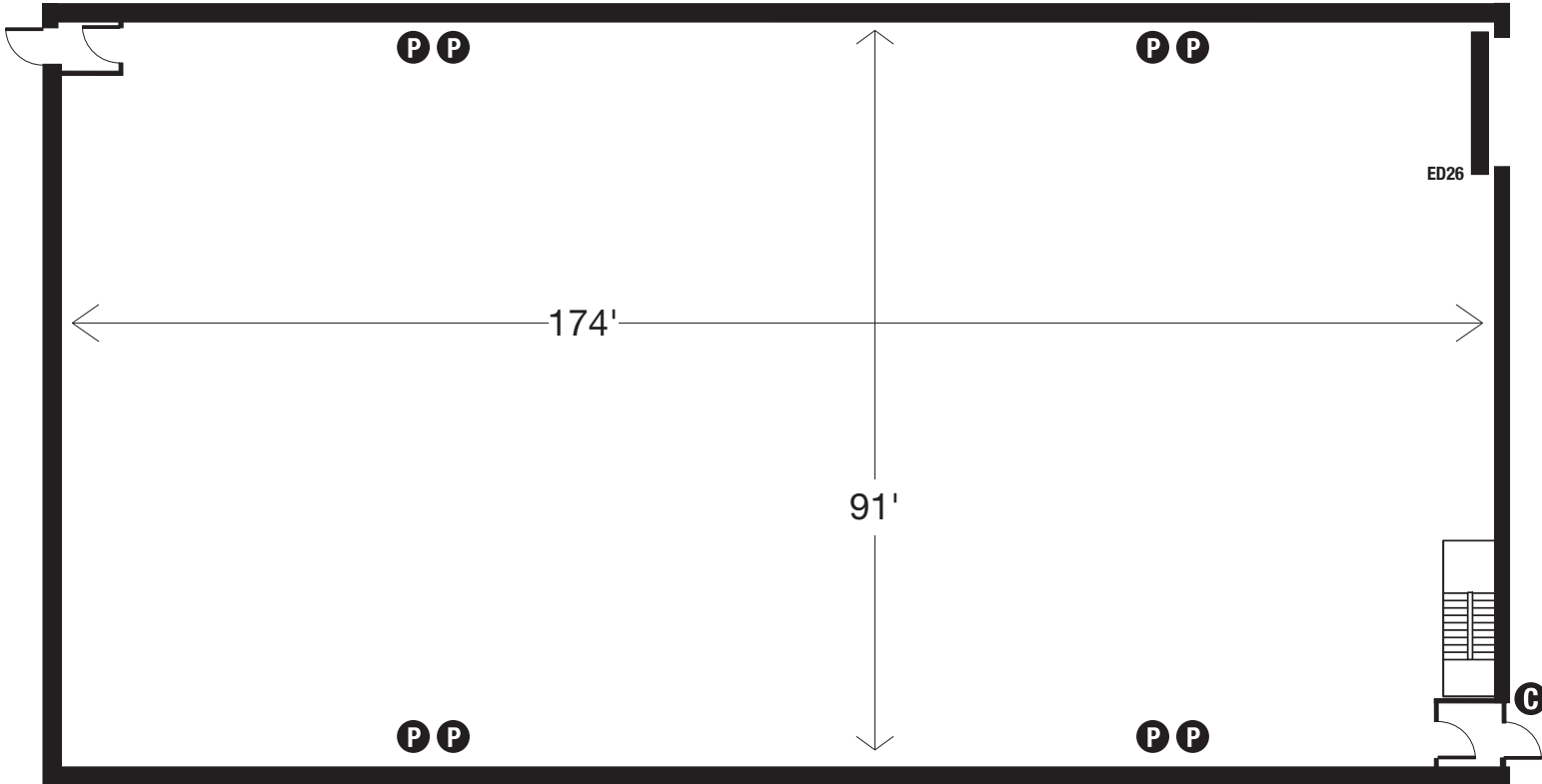

Square Footage 15,900
 Length 174'
 Width 91'
 Pipe Grid Height (underside) 35'
 Elephant Door 16'H x 16'W
 Floor Masonite over Plywood

Total Power 9,600A 1Ø AC
 HVAC (Silent) 130 Tons
 P Power 400A 3Ø House Switch
 G Electronic card entry

STEINER S
STUDIOS O
15 I
WASHINGTON D
AVENUE U
BROOKLYN T
NAVY YARD S
NEW YORK S

15 Washington Avenue
 Brooklyn Navy Yard
 New York 11205
 Tel 718 858 1600
 www.steinerstudios.com